

Spreading Wings S800 Spare Parts Manual

V 1.2



www.dji-innovations.com

Spare Parts Listing

If S800 needs part replaced, please refer to the following diagram to identify the part with the NO. and components, and then make a purchase. Each package includes screws needed.

Frame Arm

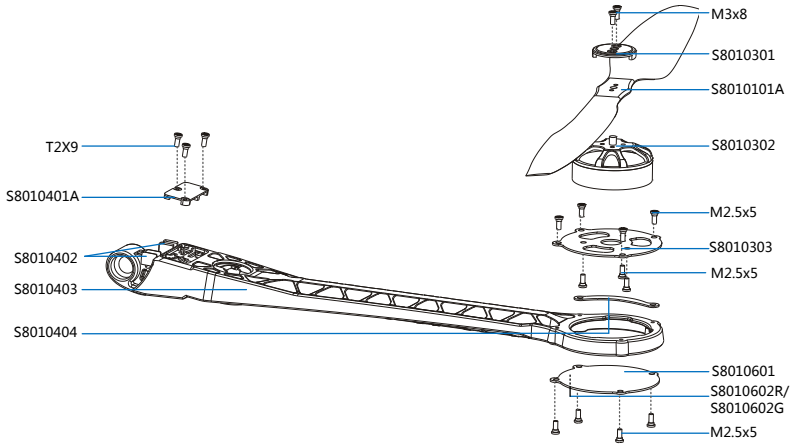

NO.	Name	Components
1	15'Propeller CCW	S8010101A
2	15'Propeller CW	S8010101B
3	4114 Motor 320KV	S8010301、S8010302、S8010303
4	Frame Arm (Counter Clockwise)	S8010401A、S8010402、S8010403、S8010404
5	Frame Arm (Clockwise)	S8010401B、S8010402、S8010403、S8010404
6	ESC (Red LED)	S8010601、S8010602R
7	ESC (Green LED)	S8010601、S8010602G
8	Frame Arm w/ Propeller& Motor& ESC	
	1. CCW & Red LED	1、3、4、6
	2. CCW & Green LED	1、3、4、7
	3. CW & Red LED	2、3、5、6
	4. CW & Green LED	2、3、5、7

Notices:

- The diagram is only for counter clockwise rotation propeller and frame arm.
- For clockwise propeller and frame arm, it is S8010101B and S8010401B.

Ensure to solder thick wires and fine wires correctly, when solder ESC to frame arm.

Clockwise and counter clockwise motor should be soldered to ESC correctly by different color order.

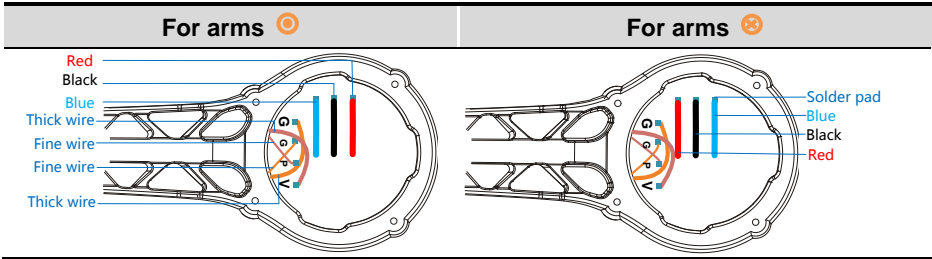

Center Frame

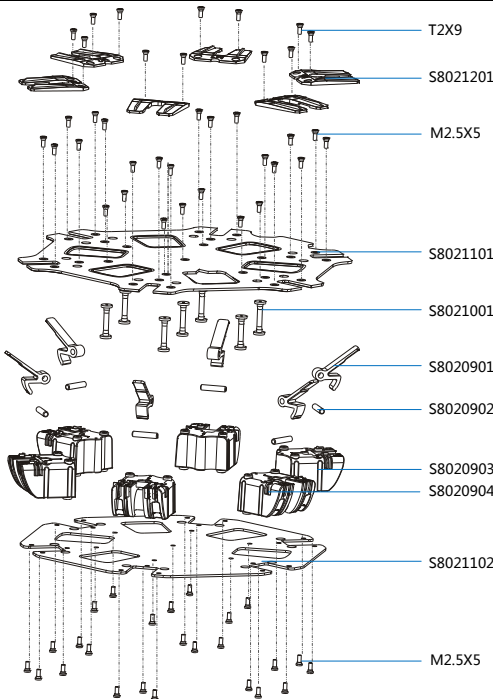

NO.	Name	Components
9	Arm Mounting Bracket	S8020901、S8020902、S8020903、S8020904
10	Center Frame Support Pillar	S8021001
11	Center Frame Top &Bottom Board	S8021101、S8021102
12	Top Board Cover for Arm Mounting Bracket	S8021201

Bi-pod

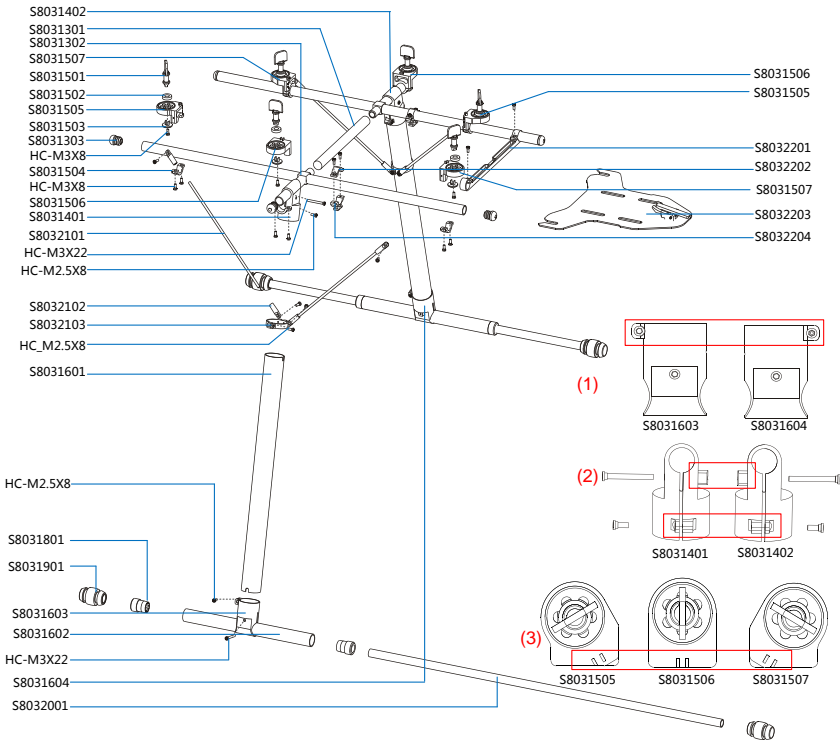

Note1: All unlabeled screws are HC-M2.5X5.

Note2: (1) Left and right T-frames are different; (2) Left and right bi-pod top mounting hubs are different; (3) Left set, middle set and right set of bi-pod carbon tube bracket are different.

NO.	Name	Components
13	H-Frame	S8031301、 S8031302
14	Bi-pod Top Mounting Hub	S8031401、 S8031402
15	H-Frame w/Bi-pod Top Mounting Hub	S8031501、 S8031502、 S8031503、 S8031504、 S8031505、 S8031506、 S8031507、 13、 14
16	T-Frame(Right)	S8031601、 S8031602、 S8031603
17	T-Frame(Left)	S8031601、 S8031602、 S8031604
18	T-Frame Nonslip Damper (4pcs)	S8031801
19	T-Frame Silicone Rubber Damper (4pcs)	S8031901
20	Bi-pod Carbon Tube	S8032001
21	Bi-pod Drawbar	S8032101、 S8032102(2pcs) 、 S8032103

22	Battery Tray	S8032201、S8032202、S8032203、S8032204
23	Bi-pod Carbon Tube Bracket(Left Set)	S8031501、S8031502、S8031503、S8031504、 S8031505
24	Bi-pod Carbon Tube Bracket(Middle Set)	S8031501、S8031502、S8031503、S8031504、 S8031506
25	Bi-pod Carbon Tube Bracket(Right Set)	S8031501、S8031502、S8031503、S8031504、 S8031507
26	Screw Pack M2.5X5	10pcs
27	Screw Pack M3X8	10pcs
28	Screw Pack M2.5X8	10pcs